

Safety Rules:

- Do not try to apply sleeves until you understand all of the instructions and cautions. Review instructions and cautions periodically to maintain awareness. Deviating from these procedures may result in fire and property damage and/or operator injury.
- These instructions relate only to the application of Postsaver sleeve products and not to the use of a suitable blow torch. It is your responsibility to read, understand and follow the instructions and cautions provided by the blow torch manufacturer before using the blow torch
- Ensure that the area where the sleeve is to be applied is clear of any flammable or combustible materials
- Always have a fire extinguisher and a bucket of water near the torch and work area. Do not place them in the flame path or in a location where you could not reach them should a fire break out.
- Work only in a well ventilated area
- If the sleeve is overheated fumes can be emitted, breathing these fumes can be hazardous to your health
- Do not touch or handle the sleeve until it has fully cooled
- Always wear suitable protective gloves when handling or applying sleeve products

Application Instructions

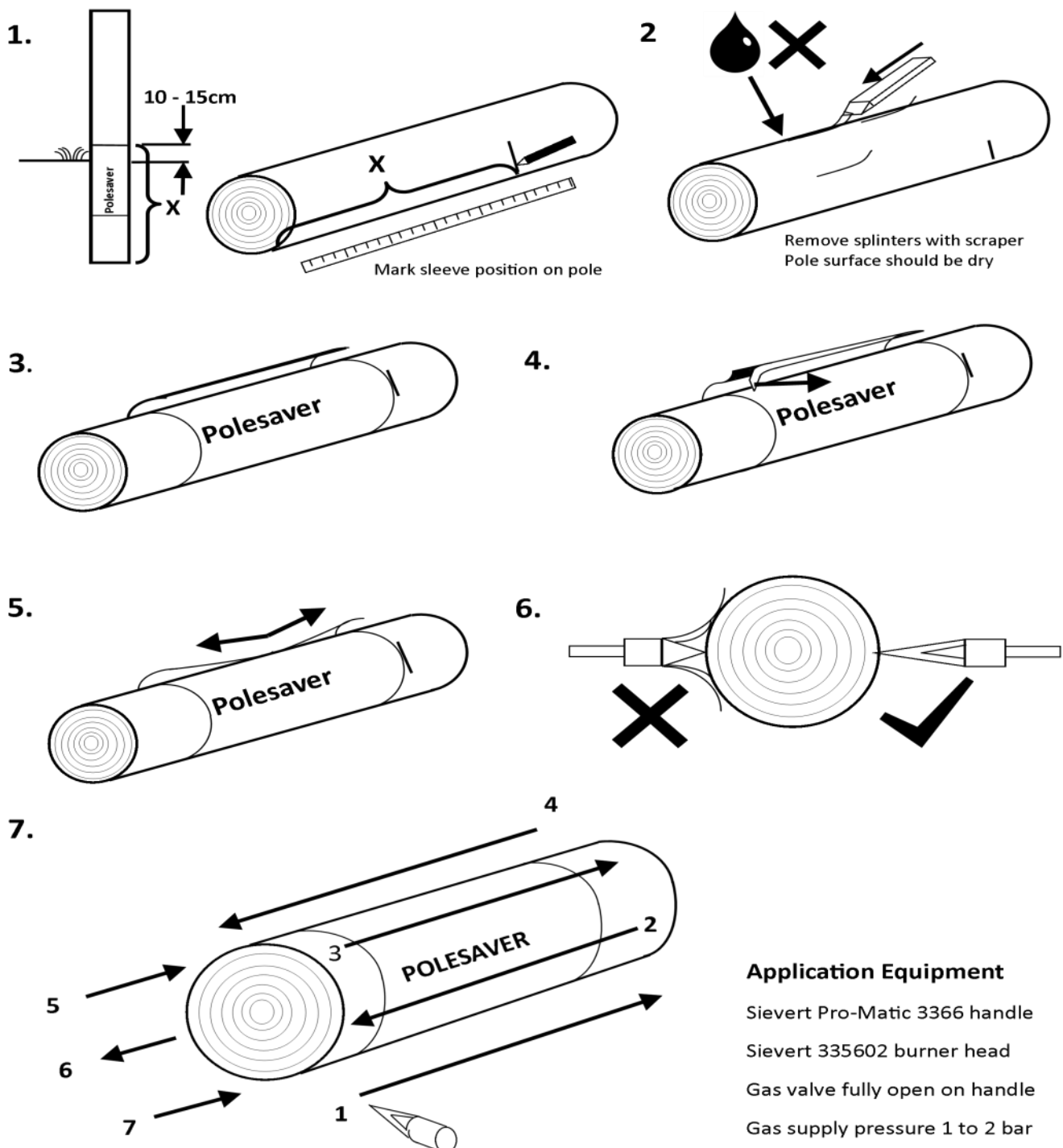

Application Equipment

- Sievert Pro-Matic 3366 handle
- Sievert 335602 burner head
- Gas valve fully open on handle
- Gas supply pressure 1 to 2 bar